



PNEUMATIC CONVEYING SYSTEMS

# BAG DUMP STATION



## OVERVIEW

Cyclonaire's Bag Dump Station offers safe and simple handling of bagged materials in a dust free environment.

Operator friendly design includes bi-fold hinged door, heavy duty bag support grate and easy bag piercing.

Self-contained fan and self-cleaning pulse jet style filter elements trap fugitive dusting for recycling.

The unit has a large work platform, easy controls and a working hopper that integrates easily into your material handling system.

Quality, custom built at competitive prices.

## APPLICATIONS

- Clean and safe unloading of bagged materials

## MATERIALS / CHARACTERISTICS

- Powdered, granular or pelletized bagged materials

## CAPACITY

- 6.3 ft<sup>3</sup> of standard hopper design

## BENEFITS AND FEATURES

- Compact, self contained unit consisting of fan, filter elements, start/stop controls and holding hopper
- Dusting from bag dumping is contained, drawn through filtration and recycled to reduce waste and fugitive dust
- Integrates easily into conveying systems
- Pulse jet filter cleaning to maintain media effectiveness
- Front access to filter elements for easy changing
- Standard
  - Carbon steel - 10 gauge
  - Hinged cover
  - 18"x40" work platform with safety grid
  - Integral dust suppression/collection,
  - TEFC exhaust fan
  - Solid state timer board with NEMA 4 control box
- Specify
  - 304 or 316 Stainless Steel
  - NEMA 4x, 7/9 hopper aeration kit
  - bag breaker
  - bag compactor

## REQUIREMENTS

- 90-110 PSIG @ 3-5 SCFM air for reverse pulse filter cleaning
- 110 VAC, 50-60 Hz

# BAG DUMP STATION

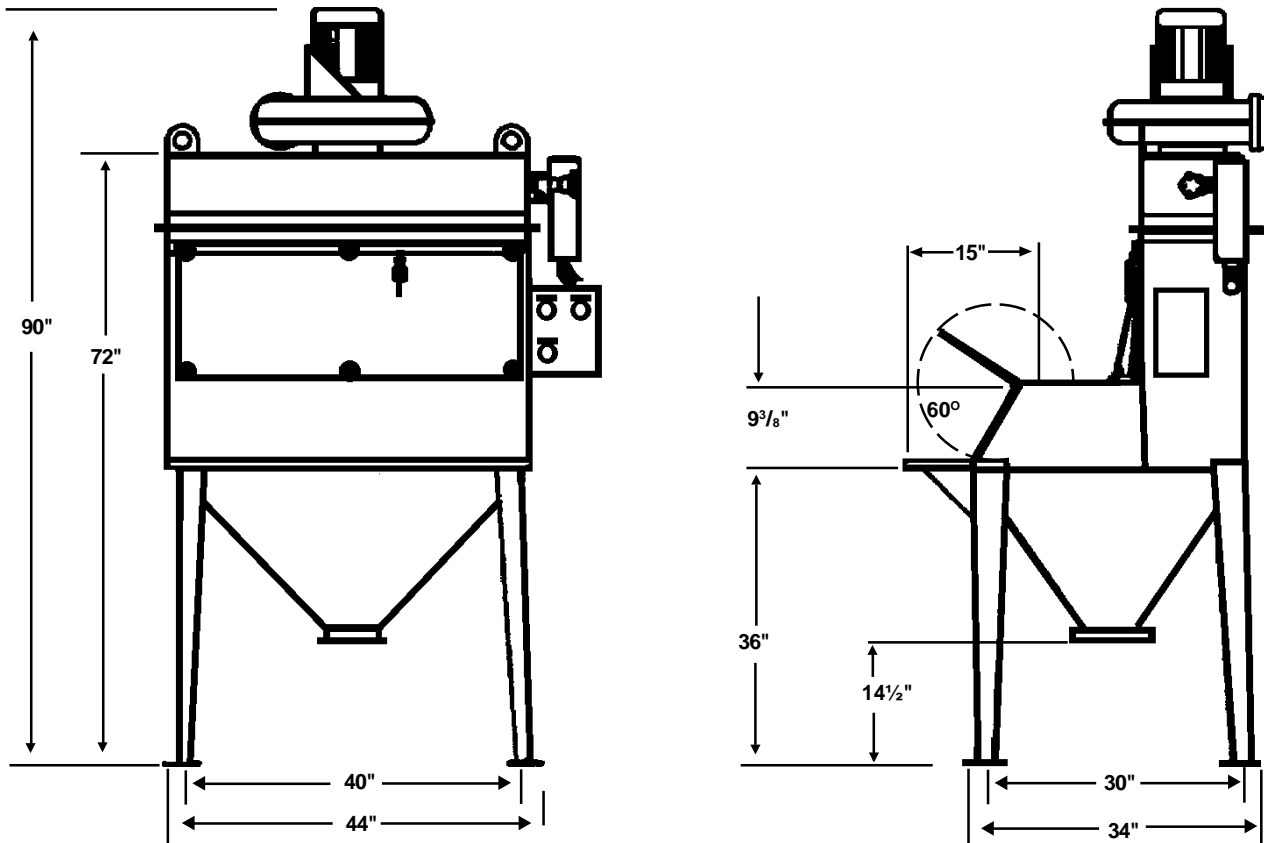

**NOTE:** Dimensional data for reference only. Subject to change without notice.  
All weights are in pounds, all dimensional units are in inches, unless noted.

## BAG DUMP STATION SYSTEM

